

2	-16	CLAMP	2-222A
4	-15	NUT	AN365-524
4	-11	COTTER PIN	M524665-132
4	-9	¼ x 1½ HARD STL ROLL PIN	2-219
1	-8	LANDING GEAR STRUT	2-219A
4	-7	BOLT	AN5-17A
8	-6	WASHER	AN960-516L
1PR	-5	BRACKET R/H & L/H	2-220 R/H 2-221 L/H
4	-4	NUT	AN310-4
As REQ	-3	SHIM WASHER	AN960-416 OR AN960-416L
8	-2	WASHER	AN960-416
4	-1	BOLT	AN4-23
QTY	No.	DESCRIPTION	P/N

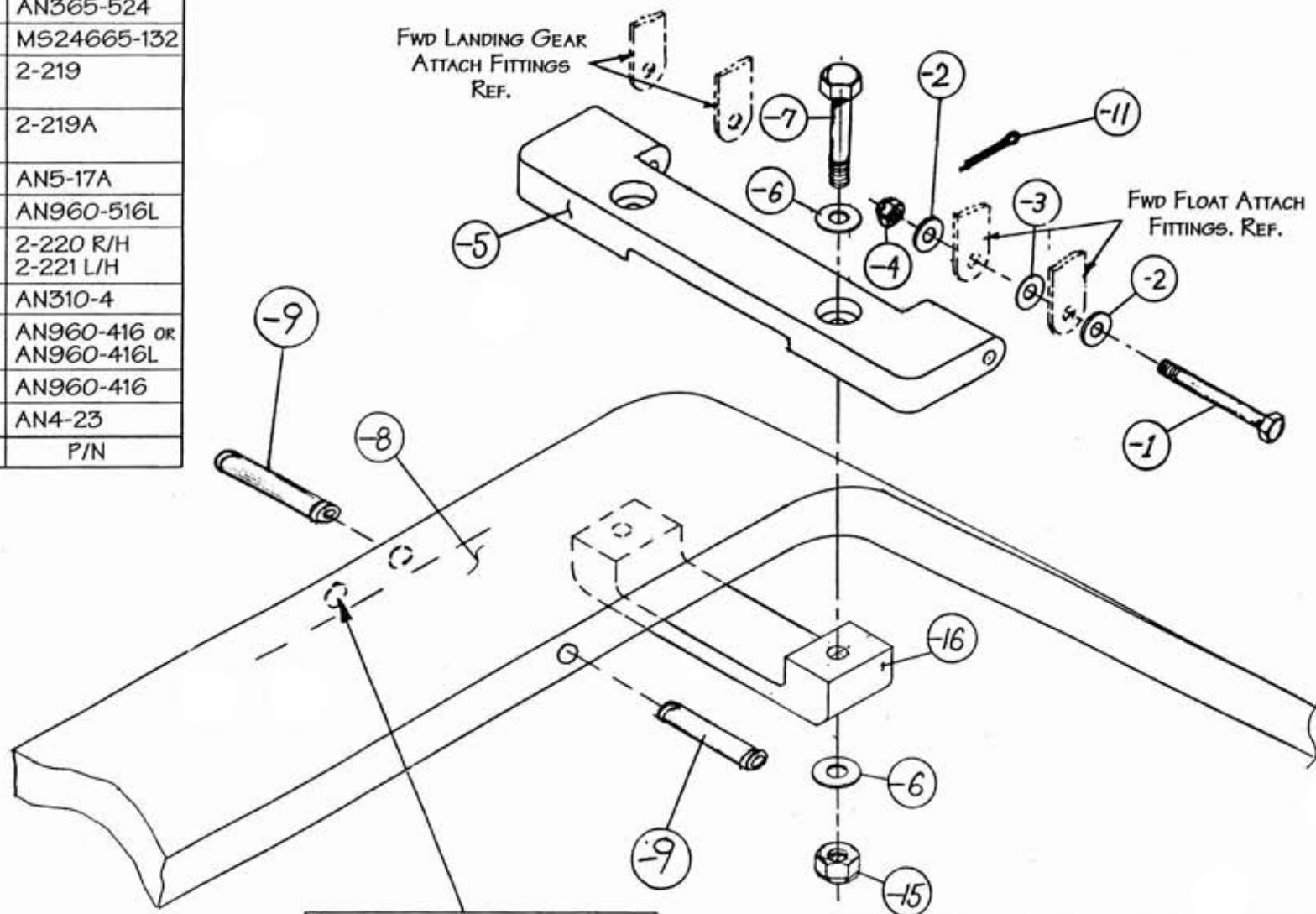

Note: Use upper gundrilled brakeline exit hole to locate rear edge of landing gear.

KITFOX MODEL III & IV SPRING ALUMINUM GEAR

INSTALLATION DRAWING | R.P. GROVE | 5-20-98

Grove Aircraft Landing Gear Systems

1800 Joe Crosson Drive (619) 562-1268
El Cajon, CA 92020 FAX (619) 562-3274